



HS225DP

Industrial wireless scanner

HS225DP industrial wireless scanner is an enhanced version of HS220, except PCB laser engraving code, metal laser engraving code, printing small barcode, low contrast barcode and wide barcode, this device's unique illumination mode makes it more effective at reading DPM barcodes on reflective, curved, and colored backgrounds.



Core advantages

■ Double-colored lighting sources, three-color illumination

Intelligently adjust the lighting mode to automatically adapt to barcodes with different background colors and materials.



■ Fill-in light with multi-color, powerful decoding

Uniquely designed lighting mode optimizes DPM code reading on curved, reflective, multi-color backgrounds.

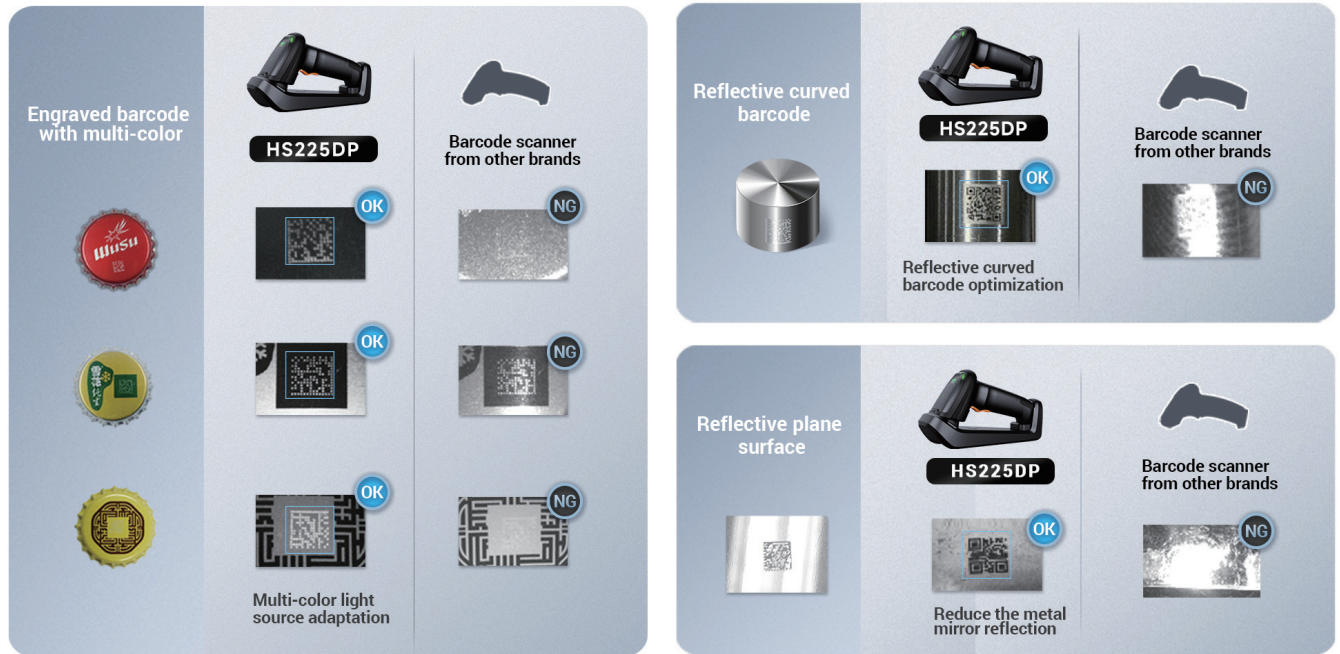

Application scenario: manufacturing industry

Assembling auto components/Mechanical manufacturing /Traceability of parts in consumer electronics repair shops/Capturing scanning data for a manufacturing production line passing station/Aviation



Performance, physical and environmental parameters

Image sensor	1280*800 COMS sensor with global shutter	
Camera Option	DPM	
Illumination LEDs	Intelligent adjustable diffuse light source: red, white, blue	
Aiming	Cross-shape laser aimer	
Sensor Speed	60fps	
Support Symbolologies	1D: Code39, Code128, Code93, Codabar, UPCVEAN, 12of5, etc. 2D: PDF417, MicroPDF417, Aztec, Data Matrix, QR code, Micro QR, GSI128, etc.	
Scan Angle	Pitch angle $\pm 60^\circ$ and skew angle $\pm 55^\circ$	
Scan Density	1D code: 3mil 2D code: 5mil	
Standard Range for Typical Symbols	Barcode type	depth of field
	3mil Code128	2cm ~ 8cm
	5mil Code128	0cm ~ 15cm
	10mil Code128	0cm ~ 22cm
	ENA 13	0cm ~ 21cm
	5mil DM/QR	2cm ~ 8cm
	6.6mil DM/QR	1cm ~ 12cm
	10mil DM/QR	0cm ~ 17cm
20mil DM/QR	0cm ~ 26cm	
Vibration motor	support	
Communication interface	RRS232, USB keyboard, USB COM	
Dimension	166.2 * 105.5 * 68.5mm	
Weight	223g+3g	
Operating temperature	32 °F to 122 °F/0°C to 50°C	
Storage temperature	-4 °F to 158 °F/-20°C to 70°C	
humidity	5% to 95% RH non-condensing	
Sealing	IP54 (Water and Dust Resistant)	
Light levels	0 to 100000Lux	
Drop Specification	Operational after 50 drops from 6 ft. (1.8 m) to concrete	
Impact Specification	2000 rounds of 0.5m tumble	
Shell material	Highly resistant industrial palstic	
Battery	Rated capacity of battery: 3150mAh; Typical capacity: 3500mah; Removable battery	
The number of full power state	supports 100000 consecutive scans at a frequency of 2 scans per second	
Charging time	using USB cable: 6~8 hours; Using external 5V power supply: about 2.5 hours	
Storage capacity in batch mode	5000 barcodes	
ESD Protection	± 15 kV Air discharge; ± 8 kV direct discharge	
Certificates	CE, FCC, RoHS, UN38.3 air transport report	



Official Website:
www.seuic.us
en.seuic.com



Service Mail:
inquiry@seuic.us
marketing@seuic.com

